

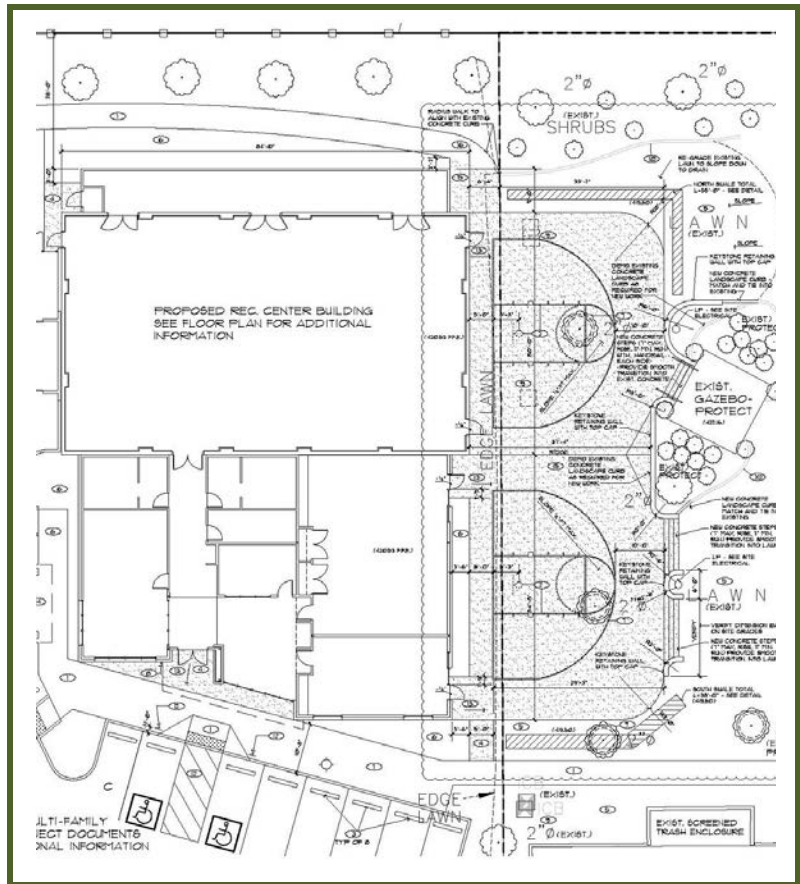

Tierra Vida Recreation Center

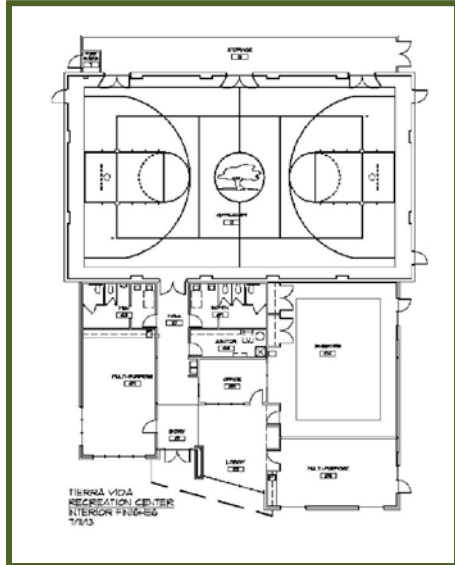

Project design team lead by DLC Architecture, LLC worked collaboratively with Construction Manager and General Contractor New Tradition Contracting, Inc. to successfully design and construct a 8,600 square foot community center facility that included a gymnasium, multi-purpose classrooms, an exercise room with an office, storage areas and other support spaces.

The building was carefully sited to blend into the multi-family housing as well as the adjacent park and Collegium building property. Site improvements consisted of two outdoor basketball play areas, site lighting, landscaping and pedestrian circulation directly adjacent to an existing park.



Project Summary

Architect/Role: David Commeree, Partner-in-Charge
 Client: Jubilee Foundation, a non-profit affiliated with Broetje Orchards, LLC.
 Address: 3425 East "A" Street Pasco, Washington 99301
 Project Type: Recreation Center- Adjacent to park and apartment complex
 Construction Cost: Not disclosed
 General Contractor: New Tradition Contracting, Inc.