



## Columbia Hills- 3 Plex Prototype Townhome



Design Rendering- Front Elevation

### Project Description

A cooperative design effort was a primary factor in the development to of this 3-plex prototype building, based on industry research of design trends and local demographics. Each unit is approximate 1,690 square feet with a total building size of 5,940 square feet.

Services provided include the following:

- Conceptual design.
- Site planning.
- Construction/permit documents.
- Coordination with structural engineer.
- Coordination with key trade partners, including pre-fab truss supplier, floor system trade partner and HVAC designer.

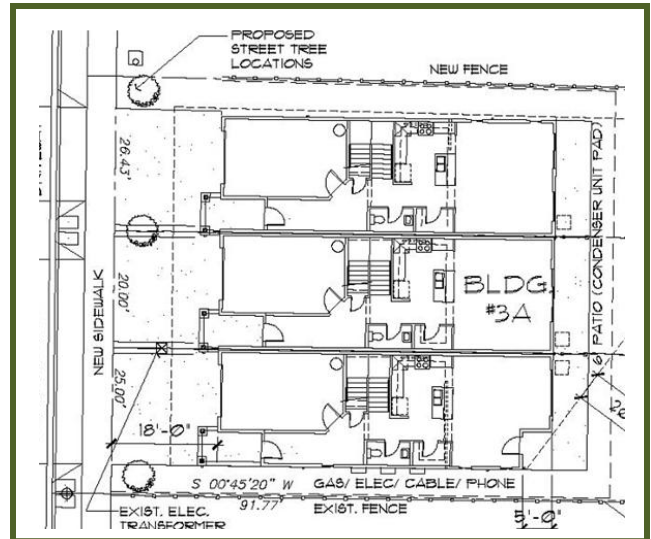

Site/ Main Floor Layout Diagram



Design Rendering- Rear Elevation

The main floors are designed with "great-room" open floor layout where kitchen is open to main living area. Stair is located in center of unit behind garage for center circulation. Upper floor has a master suite, with 2 additional bedrooms and a separate laundry room.

Exterior design focused on providing a unique identity for each unit, with variety of siding types, window locations/ sizes and paint color schemes, within an overall harmonious building design.

### Project Summary

Architect/Role: David Commeree, Partner-in-Charge  
Client: New Tradition Homes  
Address: Hillhurst Road- Ridgefield, WA  
Construction Cost: Not disclosed  
Project Area: Approx. 7,400 square feet total site area per building  
General Contractor: New Tradition Homes