



Columbia River Mental Health Services- Renovations



NorthStar Clinic- Exam Room

Company profile

Columbia River Mental Health Services (CRMHS) is a private non-profit 501(c)(3) community mental health center serving Clark County area residents. CRMHS was founded in 1942. CRMHS offers a variety of services involving adults, children and families.

Business situation

CRMHS is a dynamic non-profit organization, with very limited resources, that provides programs and services that must be adjusted and tailored to meet the ever-changing needs of the community. When new programs and services are required, building spaces must be adjusted to meet these new provisions, often resulting in the need for tenant improvements without the benefit of budgeted funding.



Scheduling Center- Careful detailing of the dark and light woods deliver strong visual impact despite a limited budget.

Technical situation

With virtually no capital improvement budget or funds to support improvement projects, the Agency maximizes its resources using a combination of efficient planning and donations from the community. Often these elements are combined to effectively design, permit and construct spaces to meet program requirements while at the same time limiting disruption to ongoing operations.



Northstar Clinic Reception- The project transformed this area, maintaining security while presenting a more professional space for client interaction.

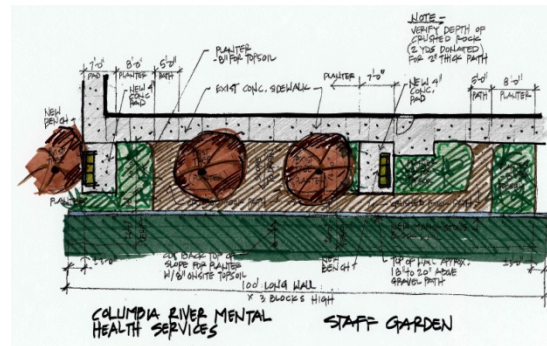

Staff Respite Garden

Solution(s)

- The Northstar Clinic was remodeled into a functioning methadone clinic in an expedited fashion (by Team Construction) from space originally constructed as a locker and shower room. This process not only minimized negative impacts to existing programs, but also allowed additional time to complete and accommodate specialized state regulatory inspections and certifications prior to the start of clinical operations.
- The Scheduling Center was designed to be accessed from a large rolling door directly adjacent to the main lobby. This project was implemented with minimal impact to existing facility operations.
- The Staff Garden was designed and constructed entirely from donated time and material. It is a peaceful place where staff and clients can enjoy a change of scenery during the workday to relax and reconnect with the outdoors.

Benefits

Given the modest resources, these projects required careful planning and design consideration, not only for functionality but also to provide, to the greatest extent possible, uplifting and inspirational spaces to accommodate people in the community with special needs and Agency staff members dedicated to providing needed services.

Services Provided

- Planning Services
- Programming Services
- Full Range of Architectural Design Services
- Building Permit Submittal and Approval Process
- Construction Administration Services

Project Summary

Architect/Role: David Commeree, Partner-in-Charge
Client: Gregory Robinson, Executive Director
Address: 6926 NE Fourth Plain Blvd., Vancouver, WA 98666
Project Type: Clinical/ Office
Construction Cost: Not Disclosed
Project Area: 1,800sf Clinic Area/ 600sf Scheduling Area (49,000sf Existing Building)
General Contractor: TEAM Construction / Volunteers at Staff Respite Garden

Project undertaken while with ARCHITECTS Barrentine.Bates.Lee AIA
Bridging design, Construction and Management
Copyright © 2010 DLC Architecture,LLC