

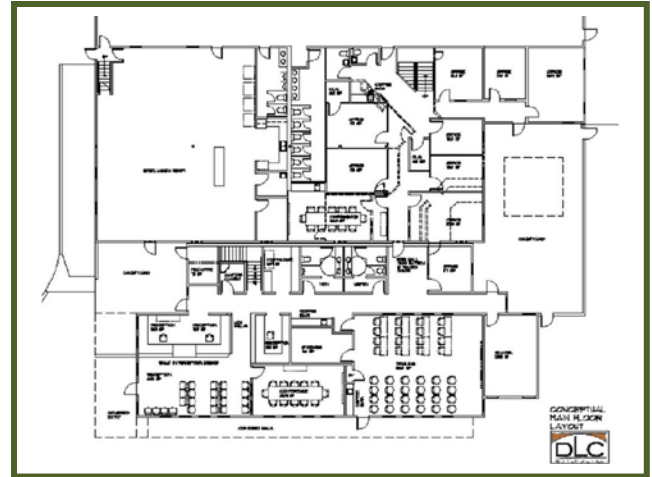

Broetje Orchard- Office Building Expansion and Renovation



Site Aerial Photo



Conceptual 1st Floor Plan

Project Description

Due to the expanding business operations and the age of the existing facilities, additional building areas were needed to accommodate office activities and functions and also to plan for future growth.

Services provided for the project included working with the facility Building Committee to outline the programming opportunities and constraints to explore possibly expanding the existing 8,000 square foot office areas, originally constructed in the late 1980's. A program summary was provided that identified the office areas needed for administrative operations and growth, as well as additional storage areas, lobbies, conference rooms, a chapel and a large employee orientation and training room. The project area was identified as 12,525 square feet.

After field verification of the existing building and parking layouts and conditions, several layouts were provided in response to the program and presented to the Building Committee. Design considerations were provided to accommodate recommended building code updates and improvements. Design efforts also explored revisions to adjacent parking areas and pedestrian circulation to improve safety and separate from shipping and receiving areas and semi-truck maneuvering areas. While working with the Building Committee, the presented options were updated and revised and culminated in the development of the preferred conceptual layout.

Project Summary

Architect/Role: David Commeree, Partner-in-Charge
Client: Broetje Orchards, LLC.
Address: Fishhook Park Road Prescott, Washington 99348
Construction Cost: Not disclosed
Project Area: Building Addition to Existing Production/Warehouse Facility
General Contractor: New Tradition Contracting, Inc.